

# BILTMOR DECK 5050

## Contents of the Biltmor box SKU # 5050

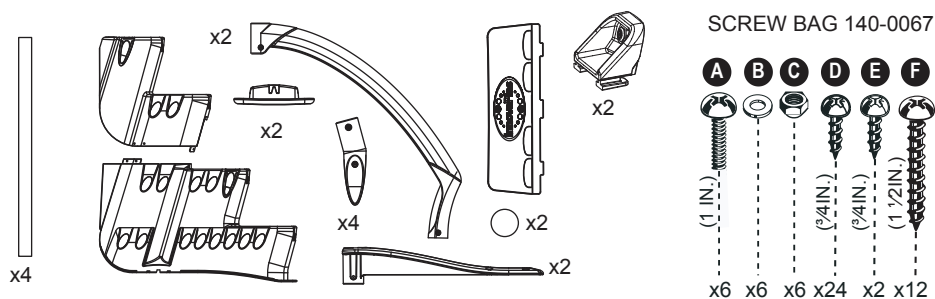

## Contents Riser kit

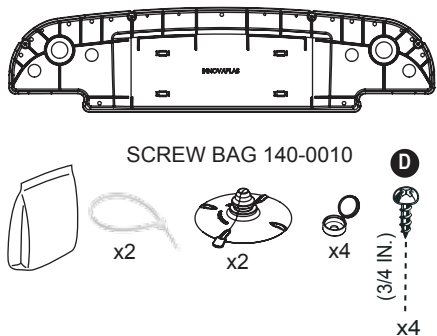

## ⚠ WARNING

- ▶ Install the step on a flat surface.
- ▶ Do not jump or dive from the step.
- ▶ Remove the step from water when temperatures drop below freezing.
- ▶ In winter, the step should be stored in an area protected from snow.
- ▶ Never lift the step by its handrails.
- ▶ Use BATTERY operated tools to avoid electric shock near water.
- ▶ Ensure no corrosive materials are added to the step or hardware kit.
- ▶ The step must be installed per manufacturer's instructions.
- ▶ File off all stripped or sharp edges before assembly to avoid injuries and liner damage.
- ▶ The manufacturer is not responsible for damages or injuries caused by improper installation or use of product.
- ▶ To ease the installation of handrails and bolts, use a screwdriver to line up the holes.
- ▶ **Maximum weight: 300 lbs / 135 kg.**

## Required tools (not included)

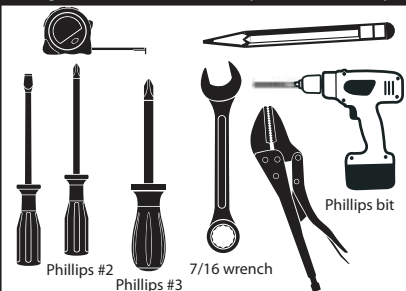

## Sand

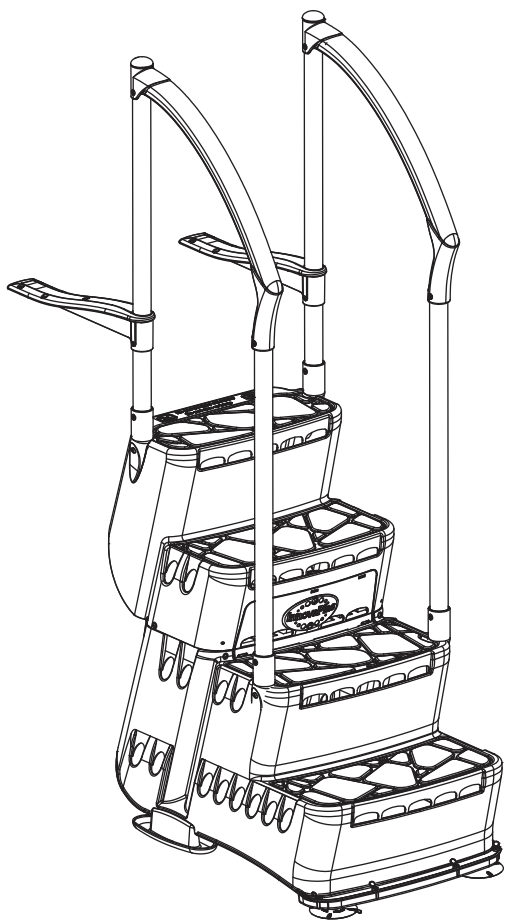
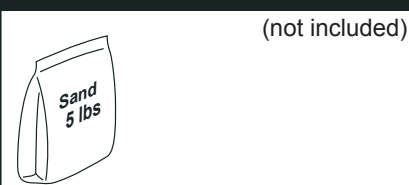

# A

- 1) Insert the two gussets in the slots and slide them toward the corners.
- 2) Assemble the two main modules with the six screws, nuts and washers provided.
- 3) Snap the door between the top and bottom module within the slots provided.

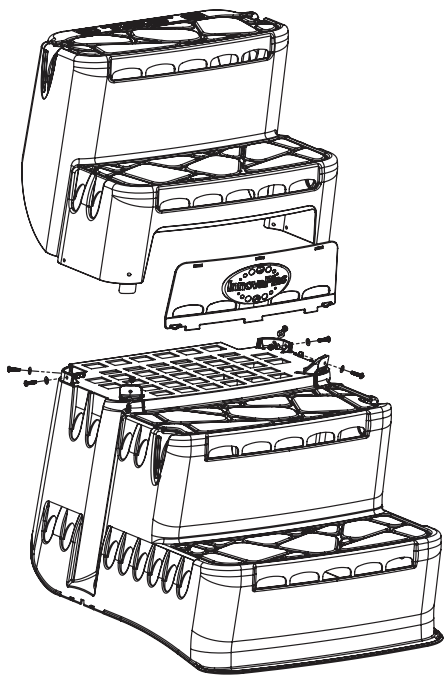
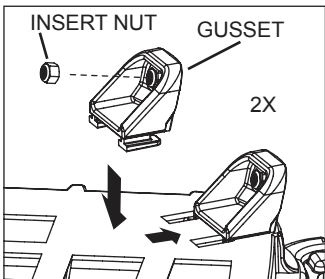
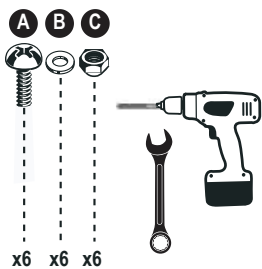

2257 route 139  
Drummondville, Québec  
J2A 2G2

WWW.INNOVAPLAS.COM

## MANUFACTURER WARRANTY

**1 year on pool step.  
1 year on hardware.**

REV. 02/07/2023

PN:

PG:1

# BILTMOR DECK 5050

## B

- 1) Snap the four post ends into the step, making sure that the cylindrical part is vertical and that the ends are snapped properly in their respective housings.
- 2) Snap the two feet to the bottom of the step.

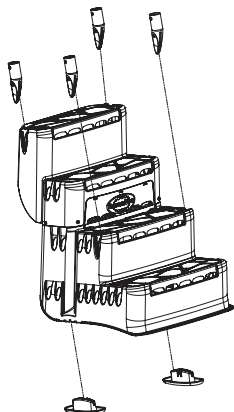

## C

- 1) Fill the bag provided with sand. The approximate weight should be 5 lbs.

\*Sand not included

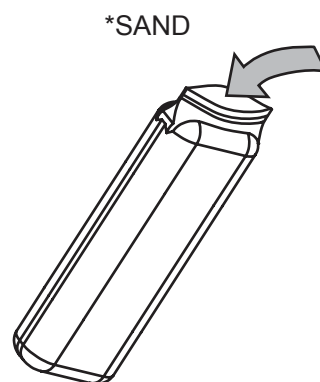

## D

- 1) Slide the two tie wraps in place and place the sand bag into the riser. Fasten the tie wraps. Do not over tighten.

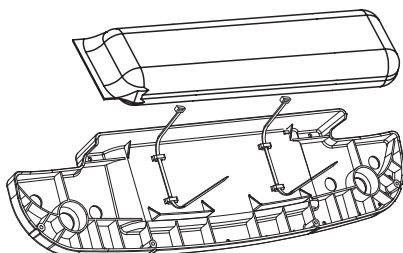

## E

- 1) Insert the two step cups in the riser.\*
- 2) Place the riser on the ground, install the step on top of the riser and fasten with the four screws and plastic screw caps provided.
- 3) Snap the screw caps covers in place.



\* View step cups installation tips on YouTube:  
<https://www.youtube.com/watch?v=W5RH1VNxpu0>

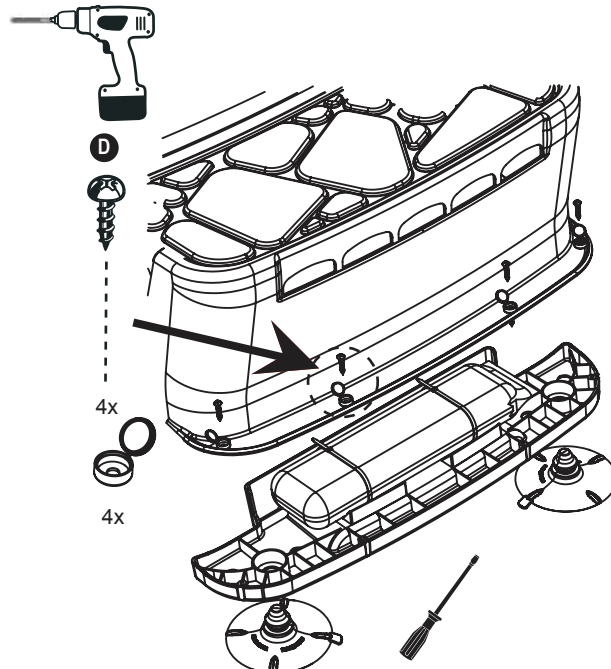

## F

- 1) Insert the four posts into the post ends and secure them in place with the screws provided (see medallion).
- 2) Insert the two deck supports over the rear posts.
- 3) Insert the handrails on the two posts and secure in place.
- 4) Fasten the access panel with the screws provided.

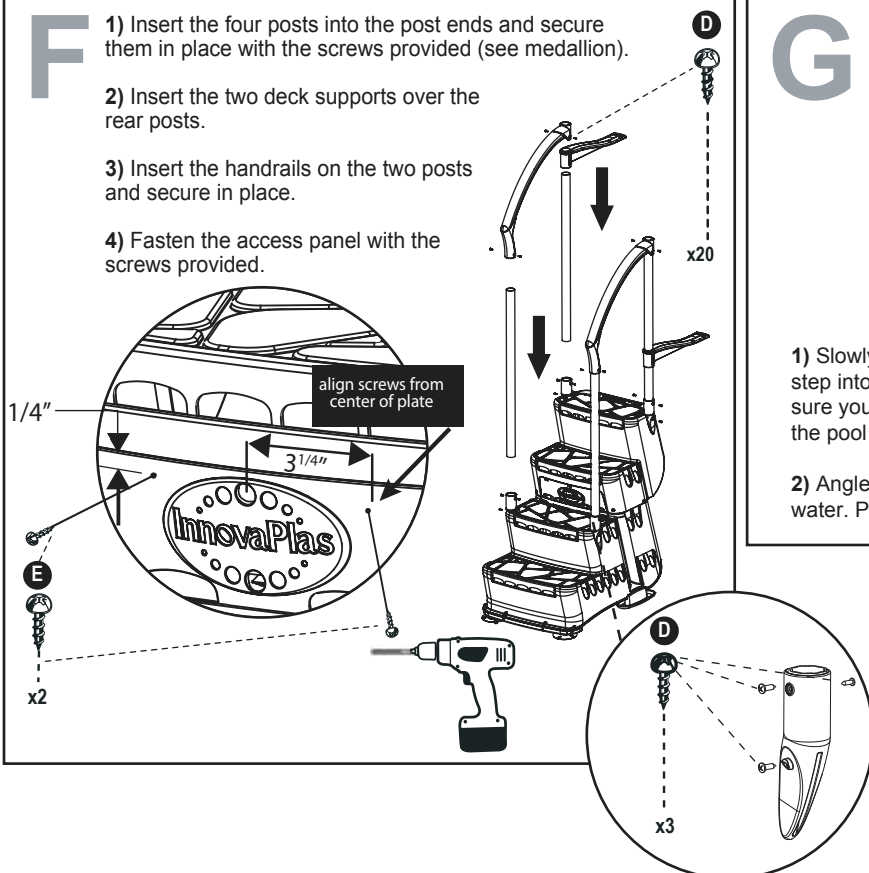

## G

- 1) Slowly submerge the step into the pool. Make sure you do not damage the pool liner in the process.

- 2) Angle the whole step so that it is entirely under water. Purge all the air from under the step.

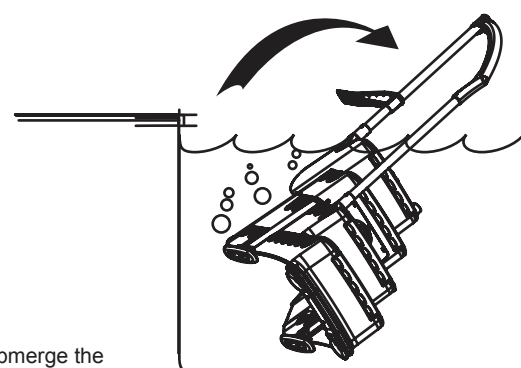

### MANUFACTURER WARRANTY

**1 year on pool step.  
1 year on hardware.**



2257 route 139  
Drummondville, Québec  
J2A 2G2

WWW.INNOVAPLAS.COM

REV. 02/07/2023

PN:

PG:2

# BILTMOR DECK 5050

H

- 1) Affix the deck supports to the deck with the screws supplied.
- 2) Install the two post covers.

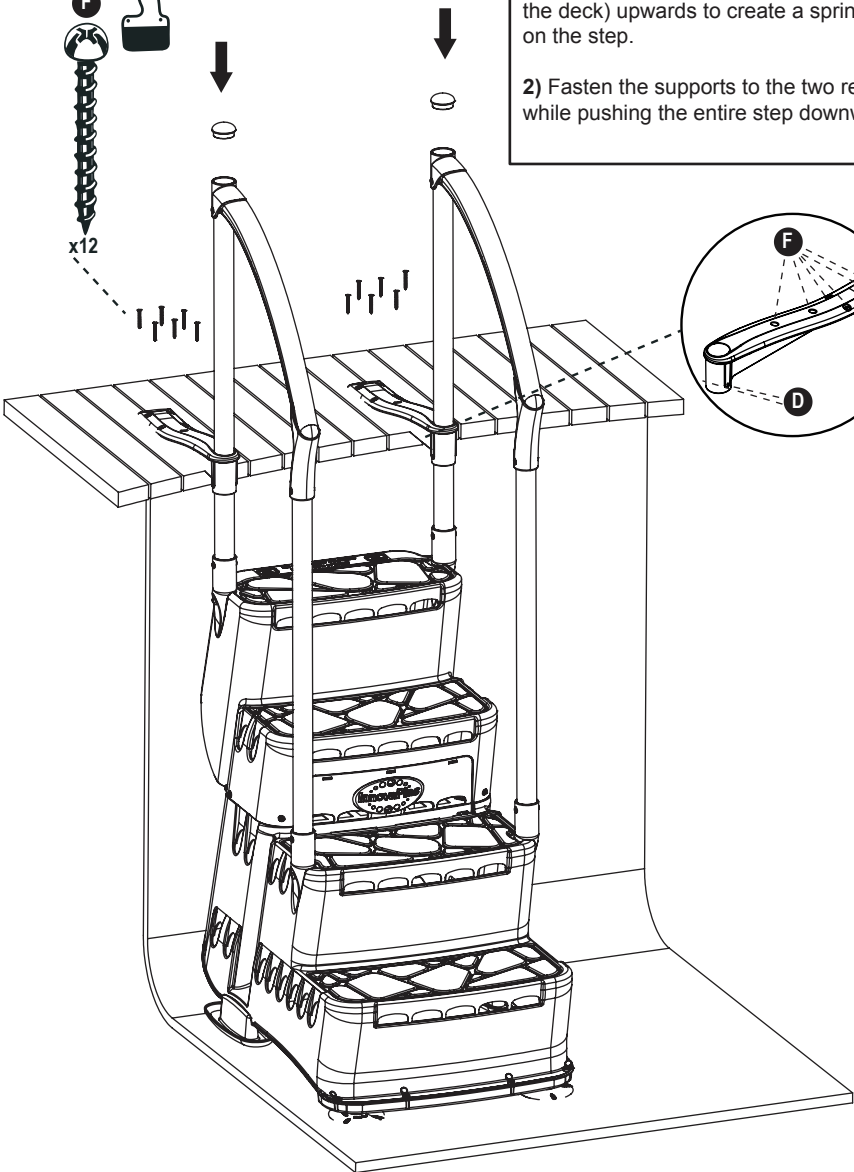
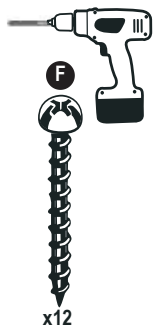

I

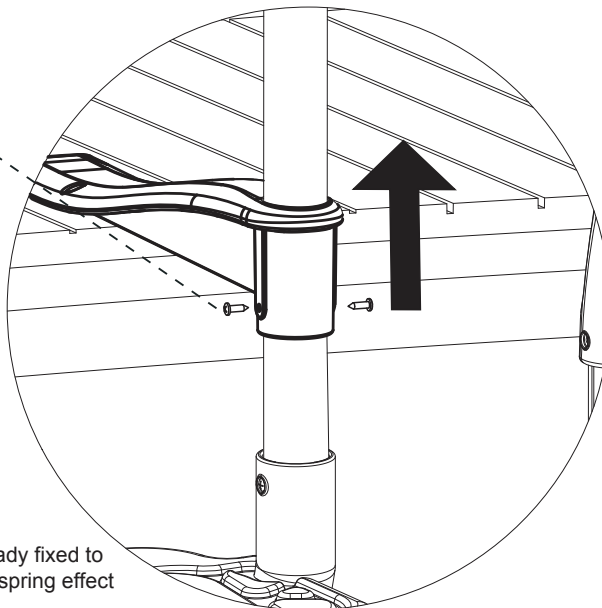
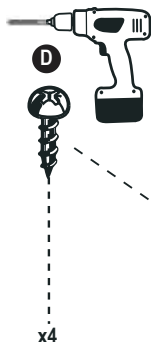

- 1) Pull the deck supports (already fixed to the deck) upwards to create a spring effect on the step.
- 2) Fasten the supports to the two rear posts while pushing the entire step downwards.

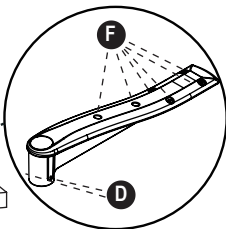

2257 route 139  
Drummondville, Québec  
J2A 2G2  
[WWW.INNOVAPLAS.COM](http://WWW.INNOVAPLAS.COM)

## MANUFACTURER WARRANTY

1 year on pool step.  
1 year on hardware.